

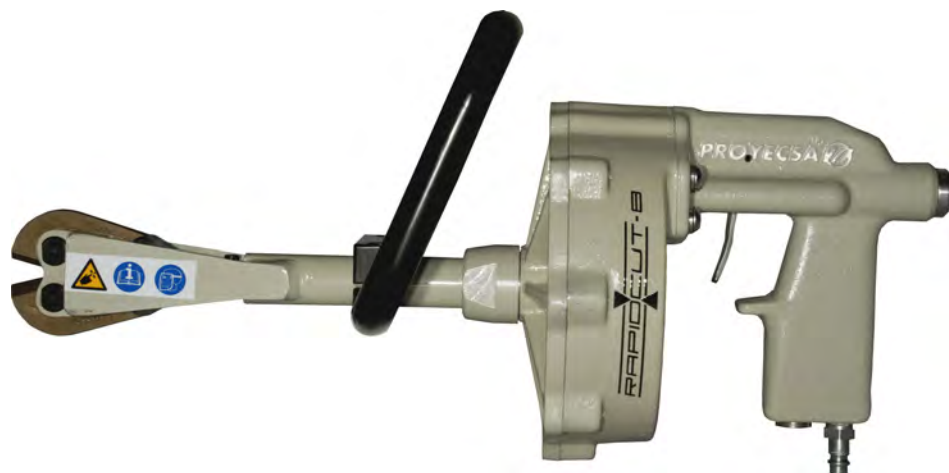

**PNEUMATIC CUTTER MOD.
Operating and maintenance manual**

RAPIIDCUT - 8

CE



CONTENTS

	Page
COMPLIANCE CERTIFICATE	3
DIAGRAM OF PARTS	4
SAFETY MEASURES AND BLADE REPLACEMENT	5
TECHNICAL FEATURES AND MAINTENANCE	6
OTHER CUTTER MODELS	7

COMPLIANCE CERTIFICATE

S.C.C.L

CONSTRUCCION DE MAQUINARIA

C/JUPITER 47 NAVE 8 POL. IND. CAN PARELLADA 08228 TERRASSA
BARCELONA
TEL. 93 7834543 FAX. 93 7855910

DECLARES, ON ITS OWN RESPONSIBLY, THAT THIS
SHEARS MOD. **RAPIDCUT** - 8

ARE MANUFACTURED TO COMPLY WITH THE SAFETY
AND ACCIDENT PREVENTION REQUIREMENTS OF THE
COUNCIL DIRECTIVE 89/392/EEC AS WELL AS ANY FU-
TURE MODIFICATIONS.

S.C.C.L

Juan Salvador
DIR. FABRICA



Gil Salvador
DIR. TECNICO



**SAFETY PRECAUTIONS
WARNING**

For your own safety, please carefully read and follow all the safety precautions before attempting to operate the tool. These must be followed at all times to ensure safe operation.. Improper use can cause serious injury.

ASSEMBLING THE CUTTER **RAPIDCUT - 8**

*-The details in this manual are simply for information
 *-The manufacturer may modify this manual without being liable for the damage cause

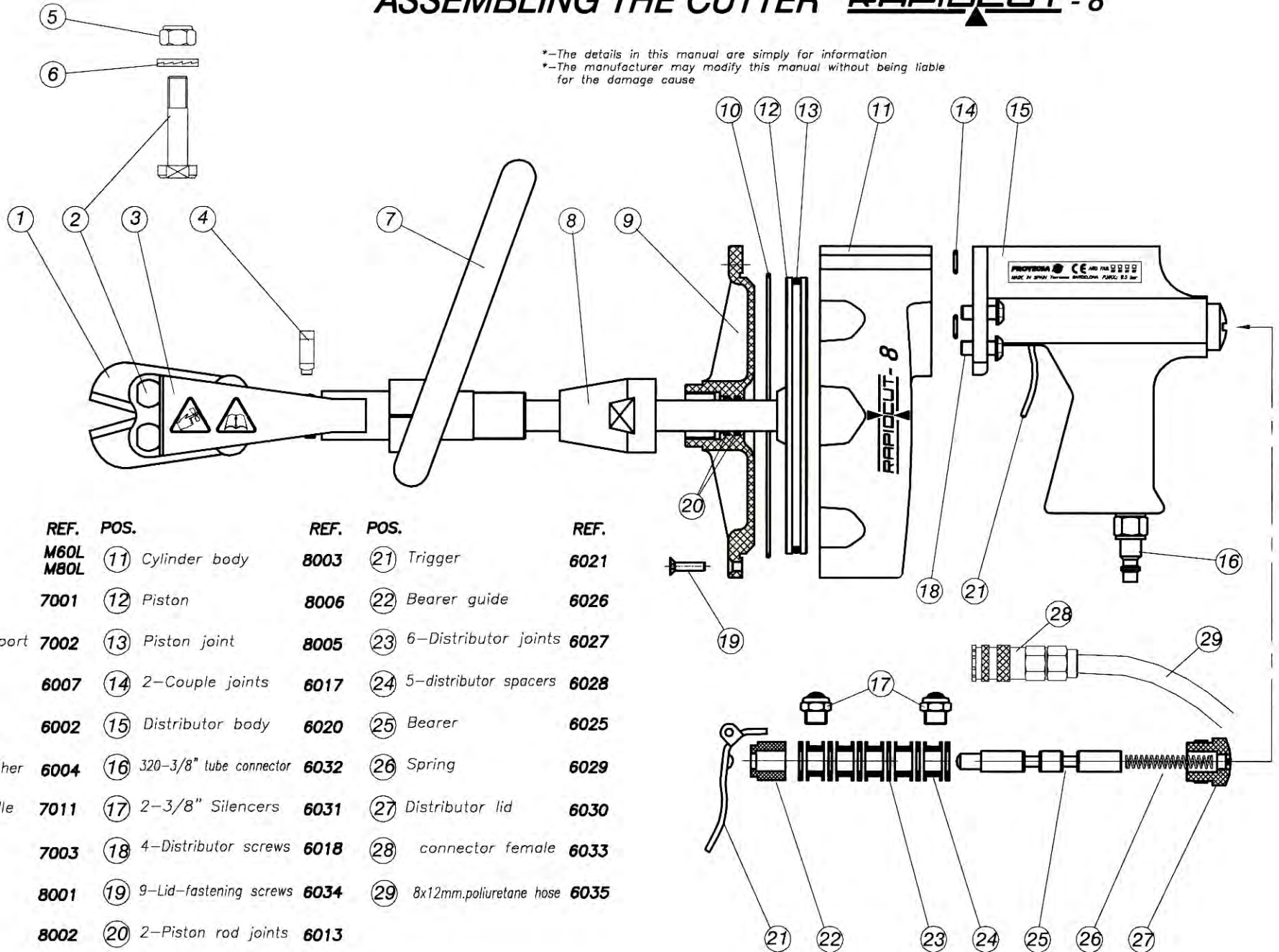

POS.	REF.	POS.	REF.	POS.	REF.
① Set of blades	M60L M80L	⑪ Cylinder body	8003	⑳ Trigger	6021
② 2-Front axle	7001	⑫ Piston	8006	㉑ Bearer guide	6026
③ Rear guide support	7002	⑬ Piston joint	8005	㉒ 6-Distributor joints	6027
④ Hinge bolt	6007	⑭ 2-Couple joints	6017	㉓ 5-distributor spacers	6028
⑤ Female screw	6002	⑮ Distributor body	6020	㉔ Bearer	6025
⑥ NORD-LOCK® washer	6004	⑯ 3/20-3/8" tube connector	6032	㉕ Spring	6029
⑦ Subjection handle	7011	⑰ 2-3/8" Silencers	6031	㉖ Distributor lid	6030
⑧ Counter nut	7003	⑱ 4-Distributor screws	6018	㉗ connector female	6033
⑨ Rear lid	8001	㉙ 9-Lid-fastening screws	6034	㉘ 8x12mm.poliuretane hose	6035
⑩ Lid joint	8002	㉚ 2-Piston rod joints	6013		

WARNING!!



DISCONNECT FROM AIR SUPPLY BEFORE REPLACING BLADES



KEEP OUT OF REACH OF CHILDREN



NEVER CONNECT TO A PRESSURE HIGHTER THAN 8.5 bar



THE USE OF PROTECTING GOGGLES IS RECOMMENDED

PROPER USE

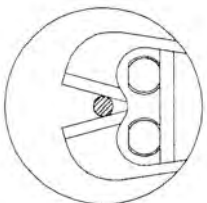

YES

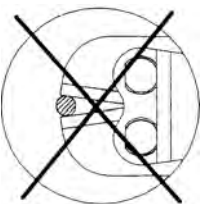

NO!

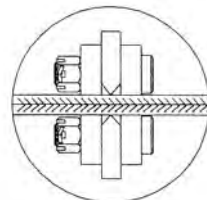

YES



NO!

BLADE REPLACEMENT



1—TO PREVENT ACCIDENTS KEEP AIR SUPPLY DISCONNECTED THROUGHOUT THE WHOLE BLADE RELACEMENT OPERATION

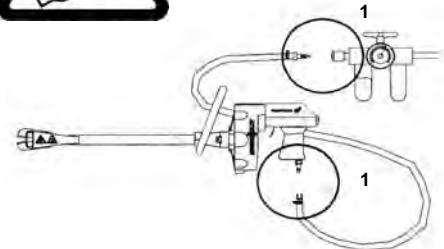

2—LOOSEN THE BOLTS AND REMOVE THE TWO HEAD AXLES, BY PUTTING IT ON A FLAT SURFACE AND HITTING THE THREAD AREA WITH A NYLON HAMMER, NOT TO DAMAGE THE THREAD.

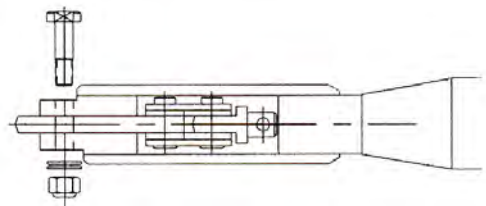

3—PULL THE TWO BLADES APART REMOVE THE BOLT FROM THE HINGE AND ASSEMBLE THE NEW BLADES IT IS ADVISABLE TO OIL ALL THE FRICTION AND TURNING AREAS DURING THIS OPERATION

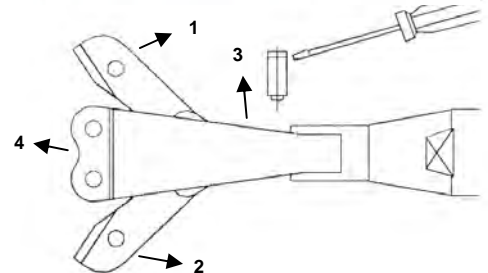

4—TIGHTEN THE FASTENING NUTS WITH AN APPROXIMATE TORQUE OF 14 Nm. IF A DYNAMOETRIC WRENCH IS NOT AVAILA-BLE, APPLY ABOUT 10 Kg. A CONVENTION-AL 12-13 mm. WRENCH

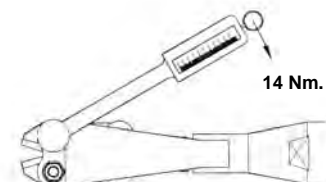

OTHER MODELS



MAX. 4 ϕ

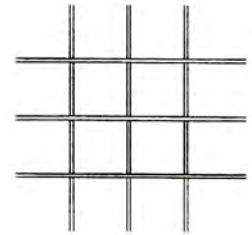
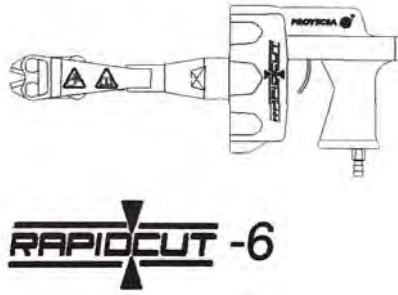

MAX. 6 ϕ

WEIGHT.....3.2 Kg.



MAX. 7 ϕ

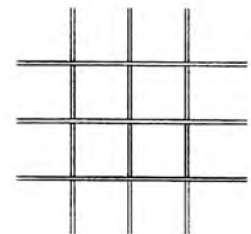
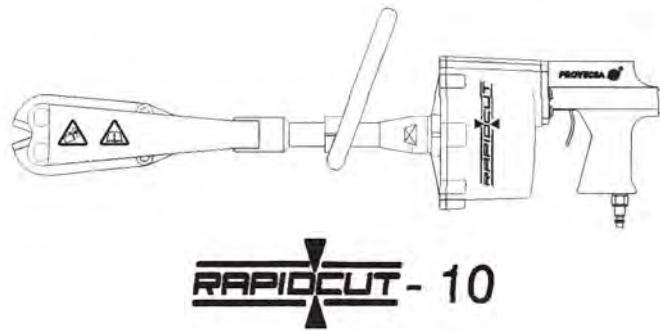

MAX. 10 ϕ

WEIGHT.....8 Kg.

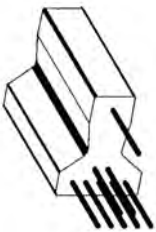

MAX. 8 ϕ

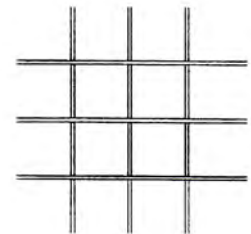
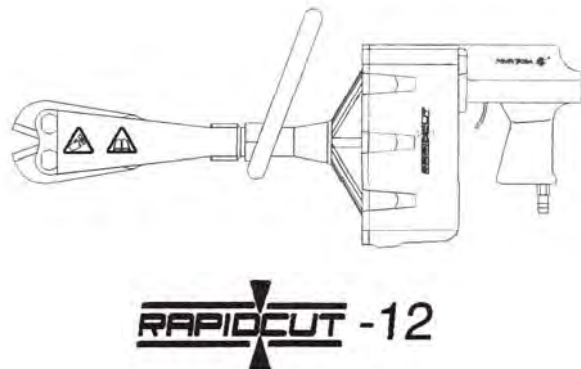

MAX. 12 ϕ

WEIGHT.....10 Kg.

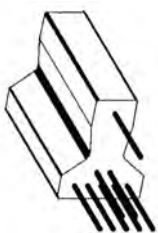

MAX. 9 ϕ

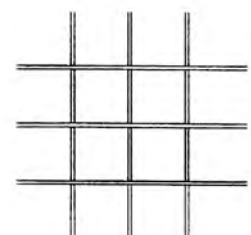
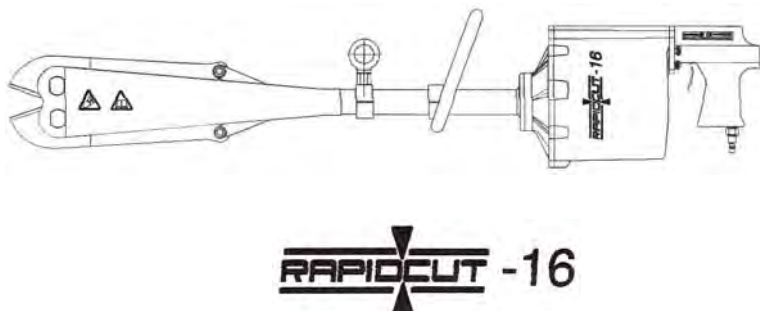

MAX. 16 ϕ

WEIGHT.....18 Kg.

